

# Taper Knob

Knob in high-resistance Duroplast allowing for high temperature resistance and durability. Long-lasting and high-tech gloss.

Standard color is black.

**Fastening**, plastic thread and zinc-plated steel or brass inserts

**Optimum utilisation** between  $-50^{\circ}$  to  $155^{\circ}$  Celsius, outstanding resistance to chemicals, oil as well as tough climatic conditions.



Most BOUTET products can be "wrapped up" in high-tech silicone rubber for an amazing softness of touch. And silicone has also the highest temperature resistance,  $280^{\circ}$  Celsius.

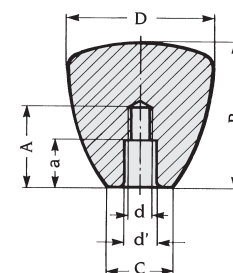

Plastic thread **with counterbore**

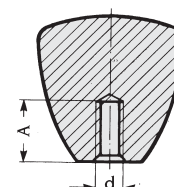

Plastic thread **without counterbore**

## Taper knob with plastic thread

D	d	B	C	a	d'	A max.	with counter-bore version Reference	without counter-bore version Reference	g	Pack
25	M6	25	12			14	-	1759	10	10 pcs
25	M8	25	12			18	-	1761	10	10 pcs
45	M10	45	20	17,5	14	36	1776	-	60	10 pcs

## Taper knob with metal insert

D	d	B	C	A'	Reference	g	Pack
25	M5	25	12	10	2271*	15	10 pcs
25	M6	25	12	12	1788	20	10 pcs
45	M10	45	20	22	1798	70	10 pcs

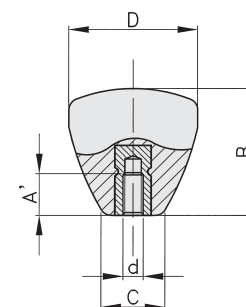

Zinc-plated steel insert (except brass in reference 2271)