

Clamp Horizontal

with adjustable spindle



Clamp in zinc plated and passivated steel.

F Fastening, supplied complete with setscrews and nuts.

This clamp is also available in stainless steel AISI 304.

lifetime warranty made by Brauer ltd

This particular product range, the toggle clamp, is not made by BOUTET. The manufacturing company is Brauer limited of England, supplying primarily the demanding automotive and aeronautics sectors with a lifetime warranty of 1 million cycles.

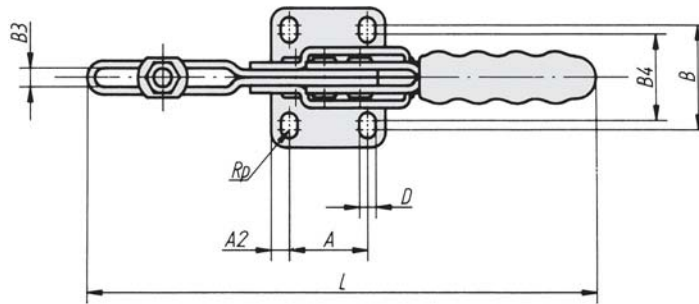
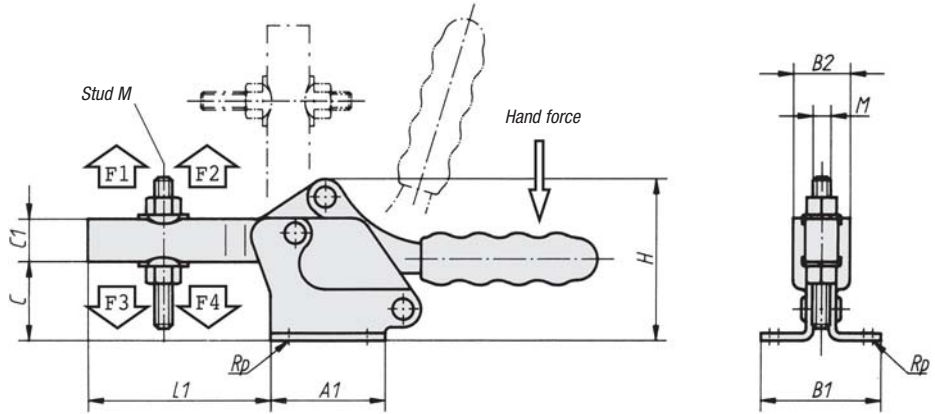

Base design for references 5795-0075 and 5795-0450

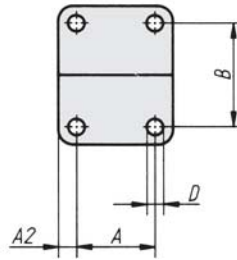

Technical data for your guidance

Reference	Arm opens through			Handle opens through			Hand force N	Holding force		Clamping force	
	Pos.1	Pos.2	without pin	Pos.1	Pos.2	without pin		F1(N)	F2(N)	F3(N)	F4(N)
5795-0075	90°	-	-	75°	-	-	80	500	1100	250	700
5795-0150	90°	-	-	80°	-	-	140	1200	2600	400	1000
5795-0250	95°	-	-	80°	-	-	200	1500	3500	800	1950
5795-0350	90°	-	-	75°	-	-	250	2500	5500	1150	3100
5795-0450	90°	-	-	75°	-	-	250	3000	6500	1150	3100

Dimensions of the clamp

Stud M	A	A1	A2	B	B1	B2	B3	B4	C	C1	D	H	L	L1	Reference	kg
M5x35	13,5	25	5,7	16,8	27	16	5,8	-	19	9,5	5,2	36	116	37	5795-0075*	0,10
M6x50	26	38	6	28	40	20	6,2	22	25	14	5,5	53	170	61	5795-0150*	0,25
M8x60	26	42	8	31	46	23	9	26	34	17,5	6,6	67	224	79	5795-0250	0,50
M10x80	41,2	59	9	43	59	30	11,4	39	45	23	8,7	91	274	108	5795-0350	0,90
M12x100	41,2	66	13	41,3	67	34	13,2	-	59	26	8,7	110	305	128	5795-0450	1,60