

Knob Triangle

high version

Product in **high-resistance Duroplast** allowing for high temperature resistance and durability. Long-lasting and high-tech gloss.

Standard color is black.

T Fastening, brass or zinc plated steel inserts.

Optimum utilisation between -50° to 155° Celsius, outstanding resistance to chemicals, oil as well as tough climatic conditions.

Product also available in **stainless steel**.



001

Prototypes of special products can be manufactured upon request, usually within a week and immediately sent to your office for comment.



Most BOUTET products can be "wrapped up" in high-tech silicone rubber for an amazing softness of touch. And silicone has also the highest temperature resistance, 280° Celsius.



RAL 6005



RAL 1021



RAL 5015



RAL 7047



RAL 9003



RAL 3020

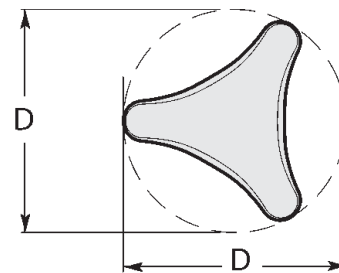

Knob "Triangle" with brass or zinc plated steel insert

D	M	H	E	A'	insert	Reference	g	Pack
32	M4	18	11	6,5	brass	3497	10	10 pcs
32	M5	18	11	6,5	brass	3498	10	10 pcs
40	M6	22	14	9	brass	103	22	10 pcs
40	M6	22	14	12	steel	2781	22	10 pcs
50	M8	28	18	14	steel	2782	40	10 pcs
62	M10	35	22	14	steel	2783	54	10 pcs

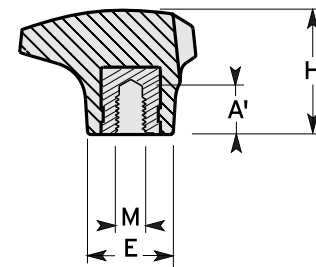

Brass or zinc plated steel insert

Knob "Triangle" with zinc plated steel stud

D	M	H	E	F	A	Reference	g	Pack
32	M6	18	11	9	15	3499	18	10 pcs
40	M6	22	14	12	15	2706	20	10 pcs
40	M8	22	14	12	20	2707	26	10 pcs
50	M8	28	18	15	20	2708	30	10 pcs
50	M8	28	18	15	30	2776	34	10 pcs
50	M10	28	22	15	25	2709	40	10 pcs
62	M10	35	22	18	25	2710	55	10 pcs

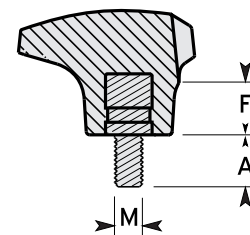

Zinc plated steel stud